



## 2N Access Unit

The innovative 2N Access Unit is based purely on IP technology. It combines the functions of a traditional controller with the functions of end access device. The unit is available in versions with keypad, RFID card reader, fingerprint reader or Bluetooth. Its characteristic design is striking, also being attractive thanks to simple installation and configuration. Naturally, it can also be connected to 2N IP intercoms, gaining you a comprehensive access control system solution which you can manage easily via 2N® Access Commander.



Office buildings  
Residential complexes  
Hospitals  
Educational establishments  
Business centres

Hotels and accommodation  
State administration public buildings  
Other staff premises

### Access security

Use 2N Access Unit to prevent unauthorised access to a building, ensuring the highest level of security for all people in the building.

### Unit with complete intelligence inside

The 2N Access Unit combines a traditional controller with end access equipment and an IP converter, significantly reducing the costs associated with installation, cabling, and maintenance.

### Simple installation

Power over PoE and a single ethernet cable make installation very simple. You can connect a lock, exit button, or open-door sensor directly to the unit.

# 2N Access Unit



## 2N<sup>®</sup> ACCESS UNIT RFID - 125 kHz or 13.56 MHz with NFC

Standalone access unit with RFID card reader ensuring building access control, with support for various types of RFID cards, chips, and other media using 125kHz or 13.56MHz frequencies. The 13.56MHz reader version also supports NFC technology.

- Combination of controller and RFID reader in one device
- Pure IP access system solution
- Door opening via smartphone (with NFC support)



## 2N<sup>®</sup> ACCESS UNIT BLUETOOTH

Thanks to Bluetooth technology you no longer need worry about forgotten RFID cards or PIN abuse. Simply open the door with your smartphone, which only needs to be in your pocket or bag, without having to unlock it. The 2N<sup>®</sup> Mobile Key application must be installed on the mobile device.

- Configurable communication distance
- Two-factor user identification
- High degree of security

Supported modes:

- TAP in App - door-opening by pressing icon in the installed application
- Touch - door-opening by touching access unit (without the need to unlock phone)



## 2N<sup>®</sup> ACCESS UNIT FINGERPRINT READER

The access unit has a top-of-the-range, highly reliable optical sensor with fast fingerprint identification. Thanks to its unique design, it provides user comfort during identification and ensures maximum security in the given space.

- Extremely secure user identification method
- False fingerprint detection
- Designed for indoor and outdoor installation



## 2N<sup>®</sup> ACCESS UNIT TOUCH KEYPAD

Separate access unit equipped with touch keypad for inputting an access PIN. The unit is equipped with a capacitive touchscreen which reliably records and evaluates every touch.

- Configurable backlighting intensity
- Acoustic response to touch
- Silent alarm activation

# 2N Access Unit

## FEATURES & BENEFITS

### Administration via web interface

The Access Control unit simply plugs into your LAN network and, subsequently, can be easily set-up via a web interface.

### Higher security of access

To provide maximum security in a protected area outside business hours, two-factor authentication of users may be required, i.e., a combination of two different access technologies.

### Tamper protection

2N Access Unit is equipped with a mechanical protective switch. As soon as anyone attempts to damage the unit mechanically, the switch is activated and an alarm is set off.

### Entry and exit monitoring

Other expansion modules can be connected to the 2N Access Unit (for example, RFID reader, keypad, Bluetooth etc.), which can secure a door from both sides with ease.

### Invalid access data warning

If an invalid card is used to attempt access or an invalid PIN is entered several times, the 2N Access Unit immediately signals a warning to the administrator.

### 2N® Remote Configuration

Save time and money for onsite support thanks to our free service. Access all your devices remotely via secured cloud connection. Fastest response to your customers requests.

## DIAGRAM

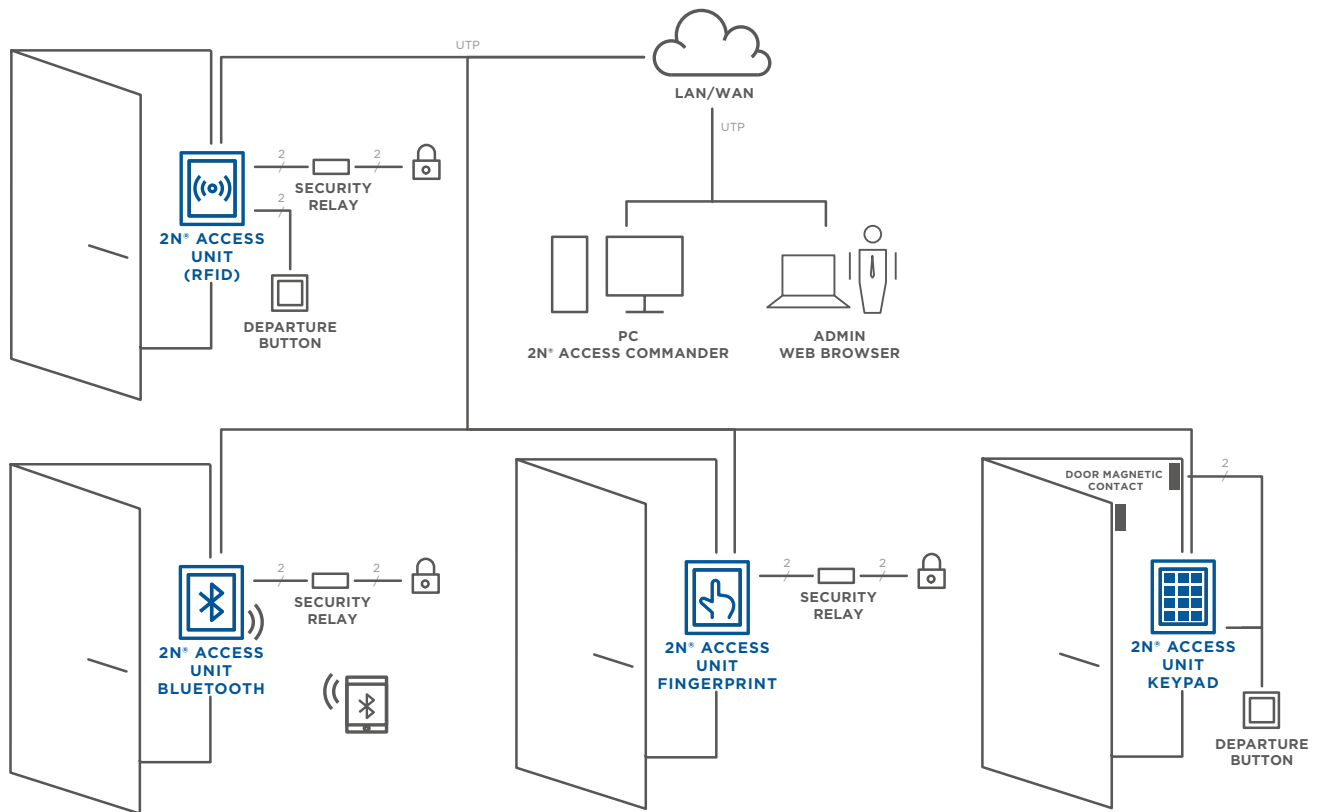

# 2N Access Unit



2N® ACCESS UNIT  
RFID

ord. 916009 (125kHz)  
ord. 916010 (13.56MHz)



2N® ACCESS UNIT  
BLUETOOTH

ord. 916013



2N® ACCESS UNIT  
FINGERPRINT READER

ord. 916019



2N® ACCESS UNIT  
TOUCH KEYPAD

ord. 916016

## TECHNICAL PARAMETERS

### Audio

Speaker 0.8 W / 8 Ω

### Interfaces

Power supply 12V ±15% / 2A DC or PoE  
PoE per standard 802.3af (Class 0 - 12.95W)  
LAN 10/100BASE-TX with Auto-MDIX, RJ-45, terminal block or pigtail RJ-45  
Recommended wiring Cat5e or better  
Passive switch NC/NO contacts, max 30 V 1 A AC/DC  
Active switch output 8 to 12 V DC / max 400 mA  
Inputs 3 inputs - can be used in passive or active mode (-30 V to + 30 V DC)

### Expansion modules

Modules supported are from the 2N® IP Verso intercom: RFID reader card (125kHz; 13.56 MHz), touch screen, keyboard, I/O module, Wiegand, etc.

### Mobile Application Support

Android 4.4 and higher, iOS 10.3 and higher

### Mechanical properties

Cover Rugged zinc die-cast with surface finish  
Operating temperature -40°C - 60°C  
fingerprint reader  
and touch keypad -20 °C - 55 °C  
Operating relative humidity 10%-95% (non-condensing)  
Storage temperature -40°C - 60°C  
fingerprint reader  
and touch keypad -20 °C - 60 °C  
Coverage level IP54

### Dimensions

Frame for surface mounting  
1 module 107 (w) x 130 (h) x 28 (d) mm  
Frame for in-wall mounting  
1 module 130 (w) x 153 (h) x 5 (d) mm  
Case for in-wall mounting (minimum size of hole in wall)  
1 module 108 (w) x 131 (h) x 45 (d) mm  
Weight Max gross weight: 2 kg / max net weight: 0.5 kg (depending on configuration)

### 2N® ACCESS UNIT RFID - 125 KHZ or 13.56 MHZ with NFC

Supported 13.56 MHz cards  
(only the serial number of the card is read)

ISO14443A	Mifare Classic 1k & 4k, DESFire EV1, Mini, Plus S&X, SmartMX, Ultralight, Ultralight C, SLE44R35, my-d move (SLE66Rxx), PayPass, Legic Advant
ISO14443B	Calypso, CEPAS, Moneo, SRI512, SRT512, SRI4K, SRIX4K, PicoPass, HID iCLASS
Supported NFC devices	Smart-phones with NFC and support for HCE (Host Card Emulation), Android version 4.3 and above
Supported 125 kHz cards	EM4100, EM4102, HID Prox

### 2N® ACCESS UNIT BLUETOOTH

Compatible with 4.0 Bluetooth and higher (Bluetooth Smart)  
Reception sensitivity up to -93 dBm  
Range more than 10 m (configurable)  
Consumption 20mA at 12V DC

### 2N® ACCESS UNIT FINGERPRINT READER

Sensor	Optical sensor protected by resistant glass
Reliability	Algorithm for fake fingerprint detection
Resistance	Resistant to water and dust
Ambient light suppression	Also works in direct sunlight
Status signalisation	Acoustic and with the aid of multicoloured LEDs
Sensing area	Large with dimensions of 15.24 x 20.32 mm
Operating temperature	-20°C to 55°C
Certification	FBI PIV

### 2N® ACCESS UNIT TOUCH KEYPAD

Capacitive technology  
High touch layer sensitivity (0.1pF)  
Regular automatic calibration (SmartSense)  
Does not detect false touches on wet surface  
Configurable backlighting intensity  
Indication using multicoloured LEDs  
Acoustic response for every keypad touch

**2N® Access Commander software** - access control and management software for 2N access unit and IP intercoms  
**2N® Mobile Key** - application that convert your smartphone to the access card  
**2N® Network Scanner** - application for detecting 2N IP intercoms and access control units on the network

## SOFTWARE